

Skimmed cylinder strainer with integrated press SVS LS

The skimmed cylinder strainer with integrated press (SVS LS) is equipment for a continual separation of suspended solids (up to 60 mm) from various type of wastewater.

The filtering element is perforated sheet metal with circle openings or a slot sieve.

Wastewater is brought through a flanged socket in the channel end, flows through a gravity screen on which solids are trapped. They are then pushed by rotating brushes over the strainer side edge to the press trough. Treated water flows below the screen from where it is discharged according to the design requirements.

ISO 9001

Specifications	
Rate of flow: Q	0 ÷ 20 l.s ⁻¹
Aperture size:	1, 3, 5, 8 mm or as required
Brush power input:	0,18 kW, 400 V / 50 Hz
Press worm input:	0,37 kW, 400 V / 50 Hz
Working environment:	a) interior
	b) exterior for temperature -20 ÷ 50°C with heating system input
Screening reduction:	~50%
<i>Other parameter ranges need to be consulted with the manufacturer.</i>	



Product designation: **SVS LS R x L x d**

R ... strainer radius

L ... strainer length

d ... pressing worm diameter



Upon the customer's requirement, the supply may contain a pretreated water collector with an exit branch.

Inside the press trough a pressing worm moves, dewatering screenings and moving them towards the exit branch. Delivered pressed water is brought through the channel perforated bottom to the treated water space. The space below the press must be cleaned with rinsing water, brought in intervals below the press through a solenoid valve. The screen is equipped with a hinged cover against wastewater splashing.

For exterior location the SVS LS are equipped with a double-shelled cover with an inbuilt heating unit. The heating version contains a thermostat enabling the heating system to be turned on at below zero temperatures.

Turning on, washing water supply, control of operation time and heating time is provided by a supplied electric switchboard.

SVS LS 500x1000x140 - example

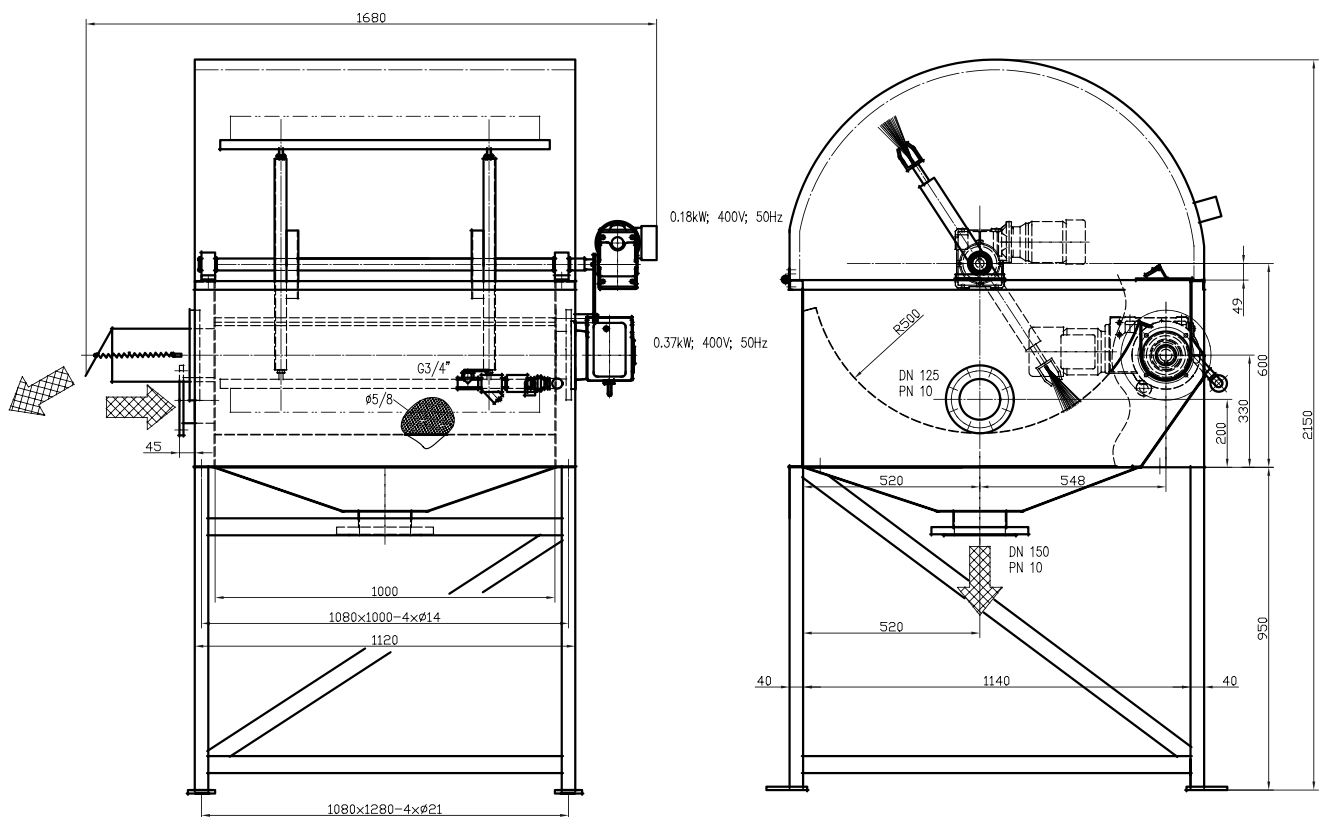

The SVS LS is made from stainless steel, bearings of rotating brushes shaft are plastic, brush bristles are made from polyamide. The shaft, rotating brushes and pressing worm are driven through separate electric transmissions.

The filtration pore sizes shall be selected upon the quantity of supplied water and character of trapped solids; it is determined by the manufacturer together with the customer.

For optimal integration of the raked roller screen with an integrated press into the WWTP technological part, FONTANA R, s.r.o. offers consultations and technical assistance in the form of a free customer service. Service within 24 (48) hours.



Fontana R, s.r.o. – P íkop 4, 602 00 BRNO, CZECH REPUBLIC

Tel.: +420 545 175 853; 545 175 848; 545 175 854; tel/fax: +420 545 175 851, 545 176 420

web: <http://www.fontanar.cz/>; e-mail: fontanar@fontanar.cz