

Mechanical fine screen – SCJ

Mechanical fine screens represent a product intended for the mechanical pre-treatment of wastewaters. They are to be installed in a WWTP inlet structure. Usual application sites include power stations, heating plants, and other energy plants, where they are installed behind coarse screens. Fine screens are designed for the collection and removal of drifted solid matter from water, e.g. leaves, remnants of plants and wood, and other mostly organic waste.

SCJs have a robust frame structure with a stainless-steel slot sieve or perforated sheet metal inserted in the rear wall.

Matter trapped in the sieve is scraped from the bottom and collected on the overflow crest. Scraping is performed with bristles of brushes fitted to holders of several carriages laid in special drive chains. The stainless steel chains with plastic pulleys are powered by an electric drive.

<i>Specification</i>	
Channel width: B	500 ÷ 3000 mm
Channel depth: H	500 ÷ 9000 mm
Chute height: V_o	acc. to container
Slot width: e	0,75 ÷ 10 mm
Level height: h	500 ÷ 5000 mm
Screen slope:	75°
Drive input power:	0.18 – 1.5 kW / 400 V / 50 Hz
Heating:	420 - 2000 W / 230 V / 50 Hz
Pressure loss: h	depends on e
Material:	a) stainless steel + plastics b) combination of galvanized carbon steel and stainless steel components + plastics
<i>Other parameters to be discussed with the manufacturer.</i>	

Product designation: **SCJ B x H / V_o x e / 75°**

Note: The manufacturer fully respects the required dimensional parameters – B, H, e.

ISO 9001

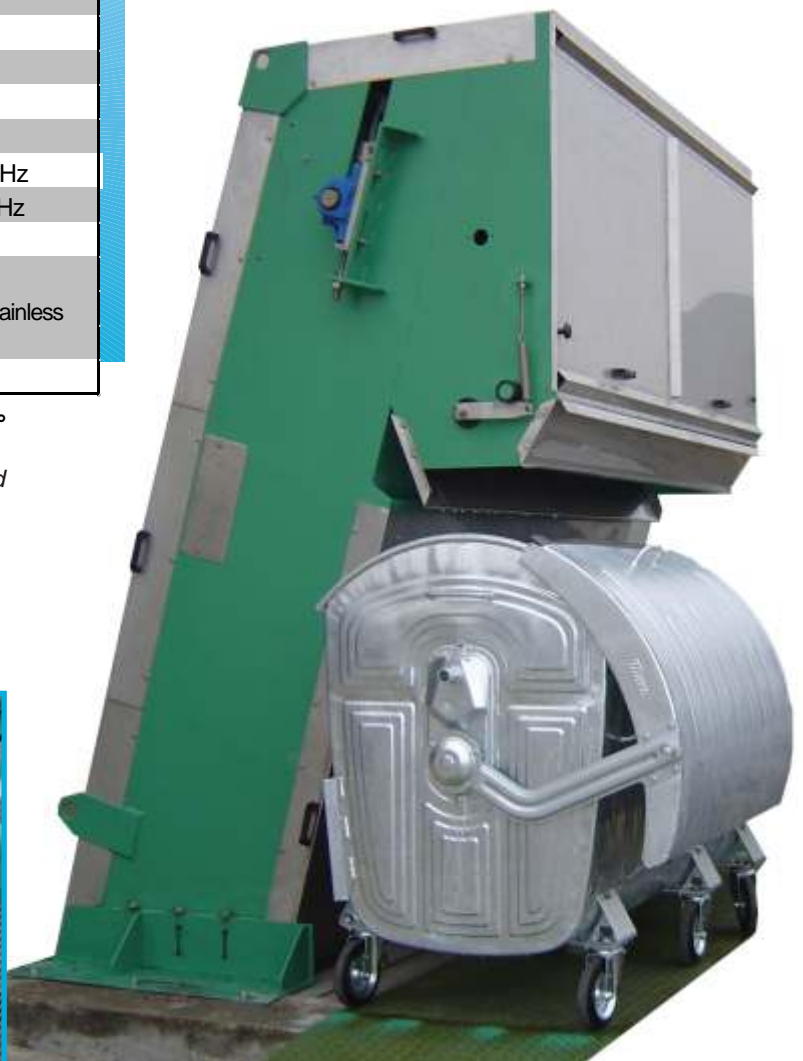

The screens are equipped with an emergency switch to prevent drive overloading. Screenings from brushes drop off spontaneously or are scraped with a scraping mechanism; alternatively they may be washed off with water. The drop height of screenings is adjusted to suit the follow-up equipment used for their disposal (container, spiral conveyor, press).

Mechanical fine screens are made of stainless steel in combination with plastics. Another option is an economical version which features screen frame made of galvanized carbon steel in combination with plastics. Both versions are further protected by a coating.

In automatic operation the screens are turned on at set intervals. Alternatively, the control panel may be equipped to turn them on according to the level height with adjustable running down.

Screens to be installed outside are further equipped with heating. Heating element are controlled by a thermostat via control panel.

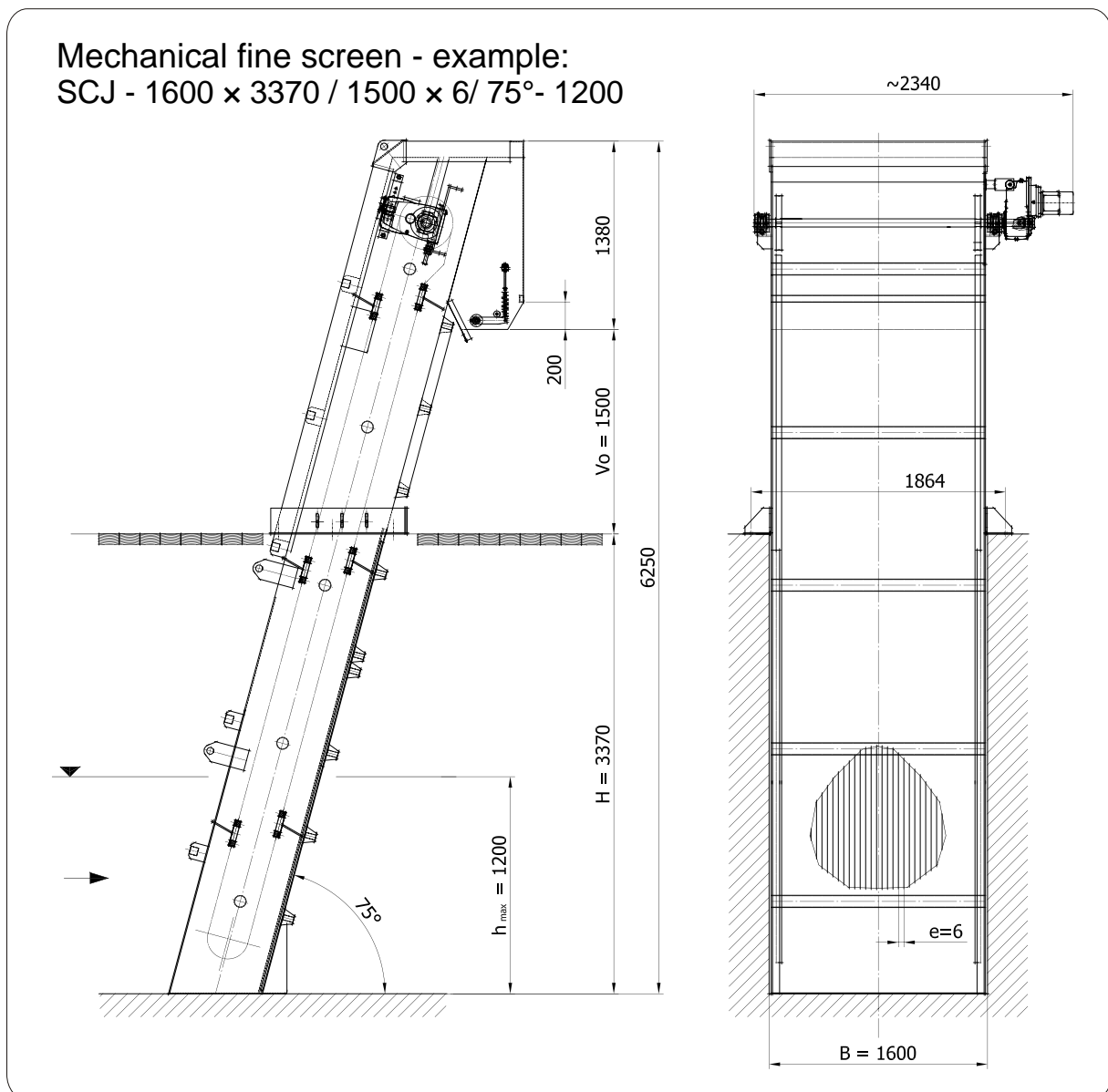

For optimal incorporation into the WWTP technological section, FONTANA R, s.r.o. offers its customers free consultations and technical assistance. Service within 24 (48) hours.



Fontana R, s.r.o. – P íkop 4, 602 00 BRNO, CZECH REPUBLIC

Tel.: +420 545 175 853; 545 175 848; 545 175 854; tel/fax: +420 545 175 851, 545 176 420

web: <http://www.fontanar.cz/>; e-mail: fontanar@fontanar.cz